

BUDYNEK JEDNORODZINNY nr 3.2a, KATOWICE, UL. KORNASA

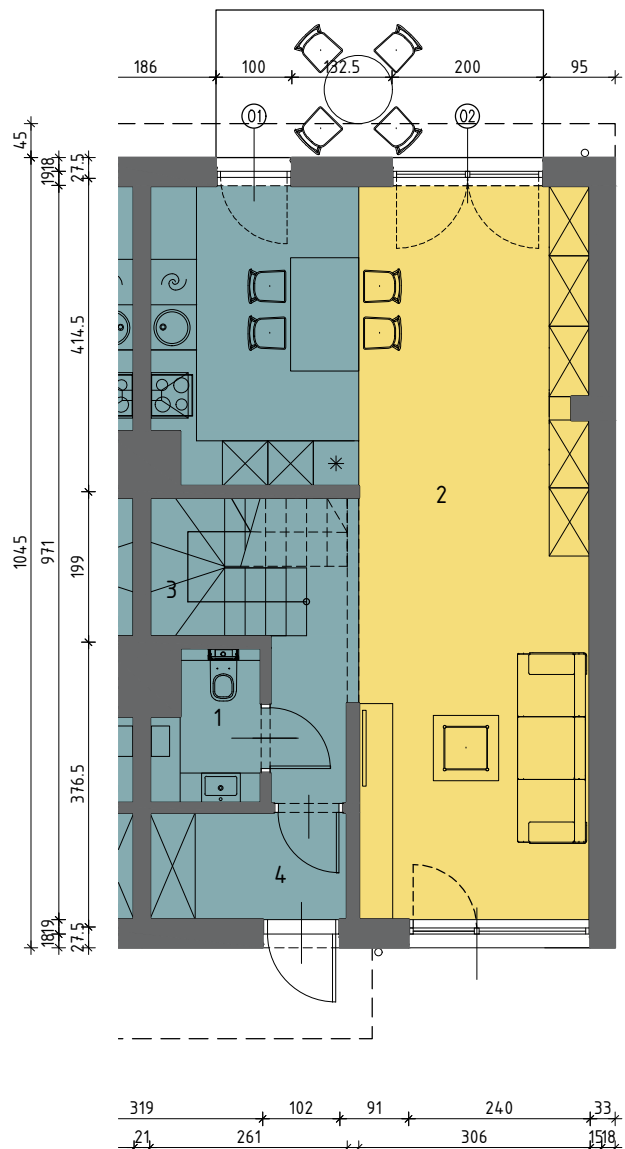

| ZESTAWIENIE POWIERZCHNI PARTERU jednego segmentu mieszkalnego | | |
|--|------------------------------|------------------------|
| nr pom. | funkcja | pow. (m ²) |
| 1 | ŁAZIENKA | 2,58 |
| 2 | SALON Z ANEKSEM KUCHENNYM | 44,06 |
| 3 | SCHODY | 1,86 |
| 4 | WIATROŁAP | 3,63 |
| razem: | | 52,13 |

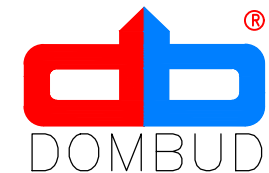
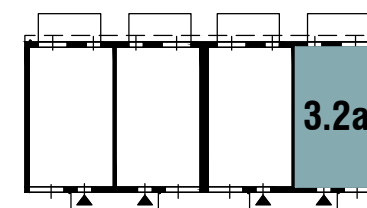
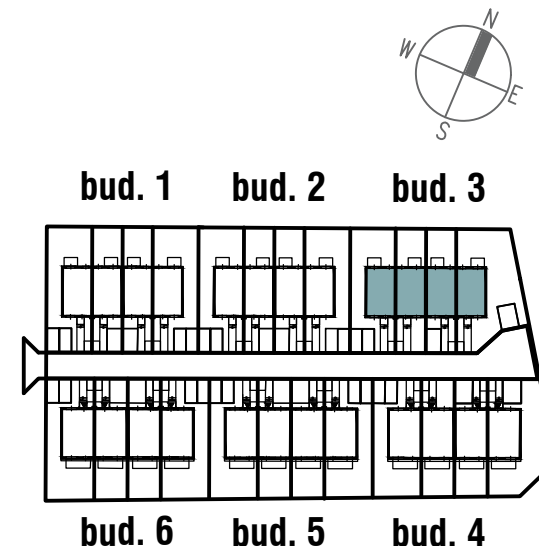

PARTER, skala 1:100